



**Environmental  
Works, Inc.**

**Gideon No. 37 School District  
Lead in Drinking Water  
Sampling and Testing Plan**

**Prepared For:**

Gideon No. 37 School District  
400 S Main Street  
Gideon, New Madrid County, Missouri 63848

**Prepared By:**

Environmental Works, Inc.  
1455 E Chestnut Expressway  
Springfield, Greene County, Missouri, 65802

**Plan Prepared:**

December 14, 2023

## Table of Contents

<b>1.0 Purpose</b> .....	<b>1</b>
1.1 Regulatory Schedule Requirements (RSMo 160.077(4)).....	1
<b>2.0 School District Description and Contact Information</b> .....	<b>2</b>
2.1 School District Information .....	2
2.2 Buildings .....	2
<b>3.0 Inventory</b> .....	<b>3</b>
3.1 Outlet Identification and Prioritization .....	3
<b>4.0 Sampling and Testing</b> .....	<b>4</b>
4.1 Initial Sampling and Testing .....	4
4.2 Subsequent Sampling and Testing .....	4
<b>Appendix A – Building Diagrams</b> .....	<b>E</b>
<b>Appendix B – Building Summary</b> .....	<b>F</b>
<b>Appendix C – Outlet Inventory</b> .....	<b>G</b>

## **1.0 Purpose**

Environmental Works, Inc. (EWI), on behalf of the Gideon No. 37 School District (Gideon 37), has prepared this Lead in Drinking Water Sampling and Testing (LDWST) Plan in response to the Missouri Revised Statutes of Missouri (RSMo) Chapter 160 Section 077 (160.077). This LDWST Plan includes procedures for inventorying and sampling outlets used for drinking water and water dispensed for cooking and cleaning of eating and cooking utensils in each of the school buildings.

This Plan has been prepared to meet the requirements of the RSMo 160.077, the Environmental Protection Agency's (EPA) 3Ts for Reducing Lead in Drinking Water, and the EPA Safe Drinking Water Act (SDWA). The Gideon No. 37 School District has distributed this LDWST Plan to the public through their website ([www.gideon.ss19.sharpschool.com](http://www.gideon.ss19.sharpschool.com)). General information on the health effects of lead contamination and additional informational resources for employees and parents of children at each school will be provided upon request.

### **1.1 Regulatory Schedule Requirements (RSMo 160.077(4))**

In accordance with RSMo 160.077, on or before January 1, 2024, each school will:

- Conduct an inventory of all drinking water outlets and all outlets that are used for dispensing water for consumption, cooking, and cleaning of cooking and eating utensils;
- Develop a Plan for testing each outlet inventoried;
- Provide the Plan to the public; and
- Upon request, provide general information on the health effects of lead contamination and additional informational resources for employees and parents of children at each school.

Before August 1, 2024, or on the first day students will be present in the building, whichever is later, each school will:

- Complete sampling in accordance with RSMo 160.077,
- Make all testing results and any lead remediation plans available on the school's website within two weeks of receiving final analytical test results, and
- Remove and replace any drinking water coolers or drinking water outlets that the EPA has determined are not lead-free under the federal Lead Contamination Control Act of 1988.

## 2.0 School District Description and Contact Information

### 2.1 School District Information

**School District:** Gideon No. 37 School District

**School Type:** Public

**Address:** 400 S Main Street  
Gideon, New Madrid County, Missouri 63848

**Phone:** (573) 448-3911 (O) and (573) 448-5197 (F)  
**Email:** jbrece@gideon.k12.mo.us

**Contact:** Mr. James Brece  
Superintendent

### 2.2 Buildings

The following table summarizes the schools covered in this LDWST Plan.

Schools	Level	Grade	Address
Gideon Building A - Elementary School	Elementary	Pre-K – 6th	400 S Main Street, Gideon, MO 63848
Gideon Building B - High School	Secondary	7th – 12th	400 S Main Street, Gideon, MO 63848
Gideon Building C - Cafeteria	Cafeteria	Pre-K – 12th	400 S Main Street, Gideon, MO 63848
Gideon Building D – Gym	Gym	Pre-K – 12th	400 S Main Street, Gideon, MO 63848
Gideon Building E - Central Office	Admin Office	Pre-K – 12th	400 S Main Street, Gideon, MO 63848

### **3.0 Inventory**

The Gideon No. 37 School District completed a building and outlet questionnaire, and EWI completed a site visit to gather information such as:

- Date of building construction,
- Year and location of plumbing repairs,
- Location where water enters the building and flow,
- Identification of any known lead lines or plumbing components,
- Location of water pipes and piping material,
- Location of any tanks in the plumbing system,
- Identification of all faucets and fixtures used for drinking water and cooking, and
- Identification of filters, aerators, signs of corrosion, or banned water cooler tanks.

### **3.1 Outlet Identification and Prioritization**

Drinking water and cooking outlets were identified from the questionnaire and site visit in accordance with the Missouri RSMo's 160.077.2 drinking water outlet definition, which includes but may not be limited to:

- a) A water fountain, faucet, or tap that is used or potentially used for drinking or food preparation and
- b) Ice-making and hot drink machines.

Building diagrams are attached in **Appendix A**, detailed information on each building can be found in **Appendix B**, and the outlets identified in the inventory are outlined in **Appendix C**.

## **4.0 Sampling and Testing**

### **4.1 Initial Sampling and Testing**

The outlet inventory and prioritization schedule included in this plan will be used to conduct sampling for the Gideon No. 37 School District. Samples will be collected using proper sampling procedures. The sampler will utilize laboratory prepared 250-milliliter (mL) unpreserved plastic containers to collect outlet water for analysis of lead by Method 200.8. Samples will be labeled, managed under a Chain of Custody, and sent to a certified laboratory for analysis. EWI personnel will collect samples from each identified outlet based on the following criteria:

#### **First Draw Sampling**

First draw samples will be immediately collected from the outlet from the first water after the outlet is turned on. Samples will be collected after a stagnation period of at least 8 hours but no greater than 18 hours.

#### **Flush Sampling**

Follow-up flush samples will be collected from at least 25% of inventoried drinking water outlets.

All results will be summarized in a final report, submitted to the Missouri Department of Health and Senior Services, and published on the Gideon No. 37 School District website.

### **4.2 Subsequent Sampling and Testing**

If initial testing finds lead above 5 ppb, the Gideon No. 37 School District will implement remedial measures, then test and sample 25% of remediated drinking water outlets by first draw and follow-up flush sampling annually.

If initial testing does not find a drinking water source with a lead concentration above 5 ppb, the Gideon No. 37 School District will complete testing and sampling every five years.

## **APPENDIX A – BUILDING DIAGRAMS**

LEGEND	
X	SINKS
○	FOUNTAINS
□	DISH WASHER
△	ICE MACHINE

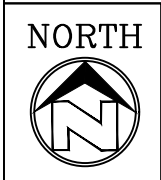
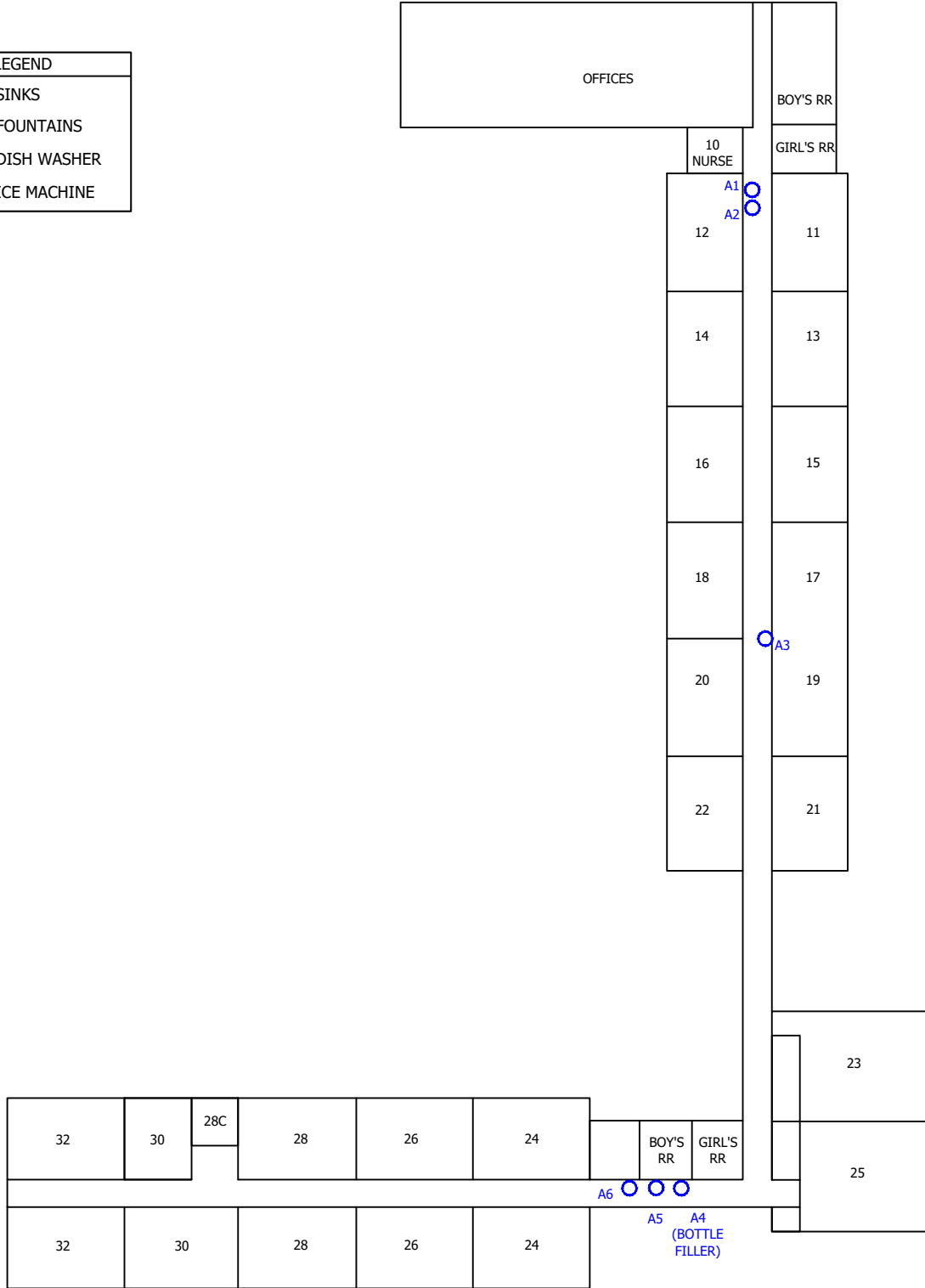

CHECKED BY:  
T. ABERNATHY

E.W.I. # 232815  
DRAWN BY: CRR  
Nov. 29, 2023

NOT TO SCALE



ELEMENTARY SCHOOL  
(BUILDING A)

GIDEON SCHOOLS  
GIDEON, MISSOURI

FIGURE  
**1.0**



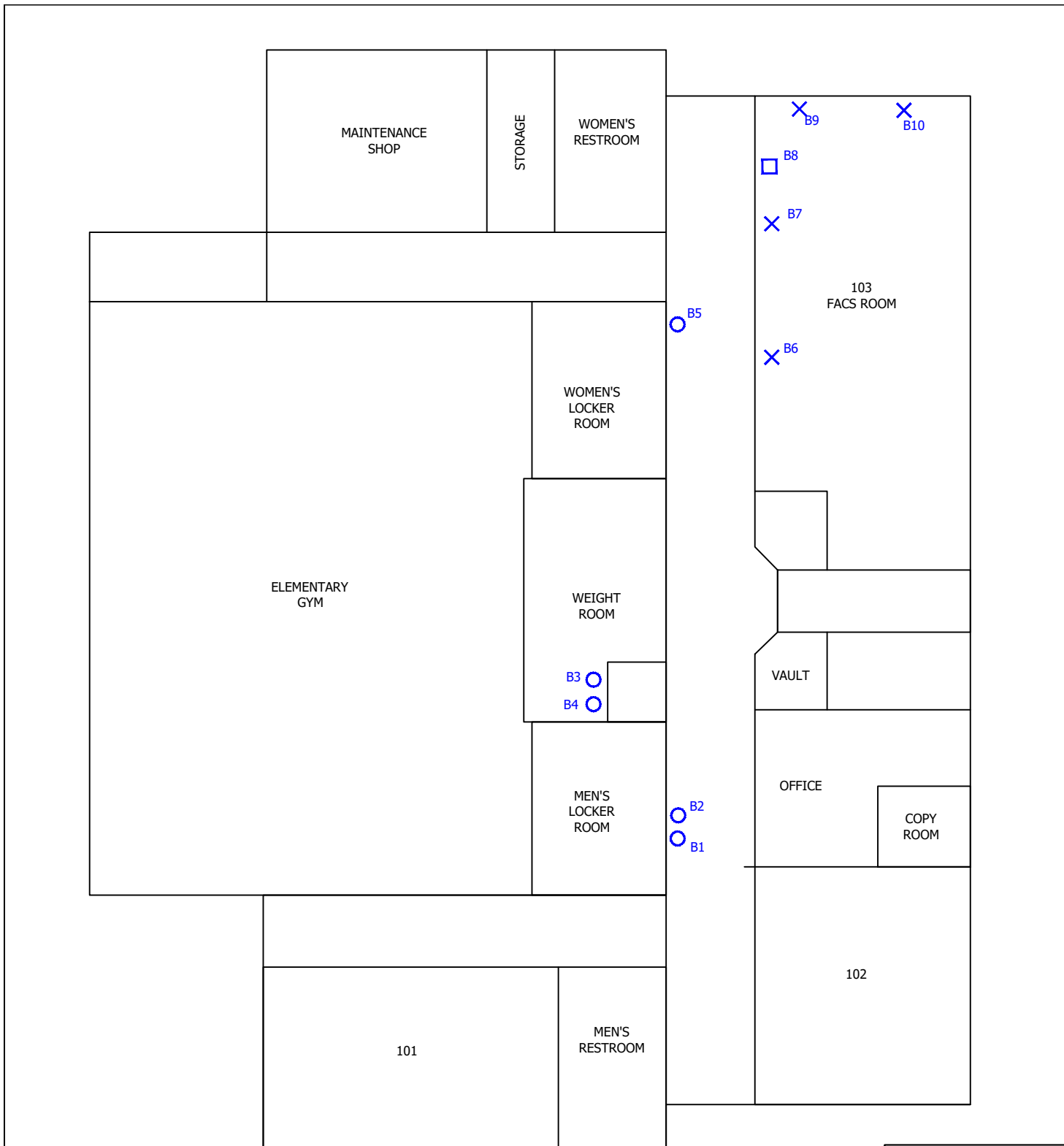

NORTH



LEGEND

- X SINKS
- O FOUNTAINS
- DISH WASHER
- △ ICE MACHINE

CHECKED BY:  
T. ABERNATHY

E.W.I. # 232815  
DRAWN BY: CRR  
Nov. 29, 2023

NOT TO SCALE



**ENVIRONMENTAL WORKS**  
2008 N. WESTWOOD BLVD, POPLAR BLUFF, MO

HIGH SCHOOL  
(BUILDING B)

GIDEON SCHOOLS  
GIDEON, MISSOURI

FIGURE

2.0

LEGEND	
X	SINKS
O	FOUNTAINS
□	DISH WASHER
△	ICE MACHINE

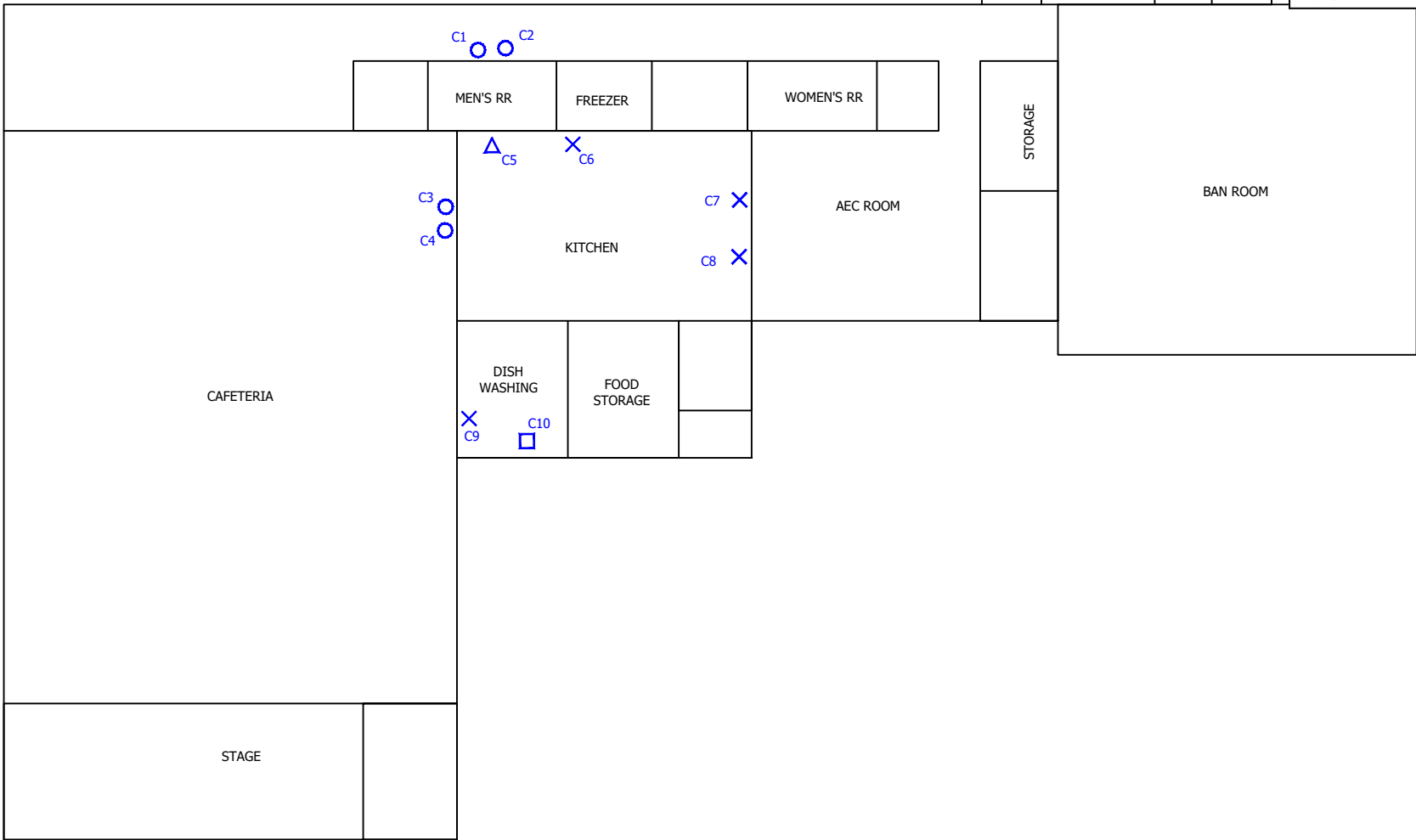

NORTH



CHECKED BY:  
T. ABERNATHY

E.W.I. # 232815  
DRAWN BY: CRR  
Nov. 29, 2023

NOT TO SCALE



Poplar Bluff Office Location  
2008 N. Westwood BLVD  
Poplar Bluff, MO 63901  
Phone: (513) 316-9300

**CAFETERIA/BAND  
(BUILDING C)**

GIDEON SCHOOLS  
GIDEON, MISSOURI

FIGURE

**3.0**

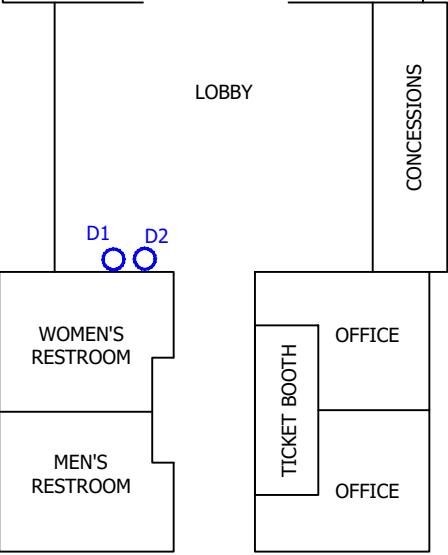
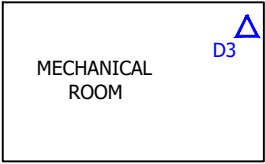
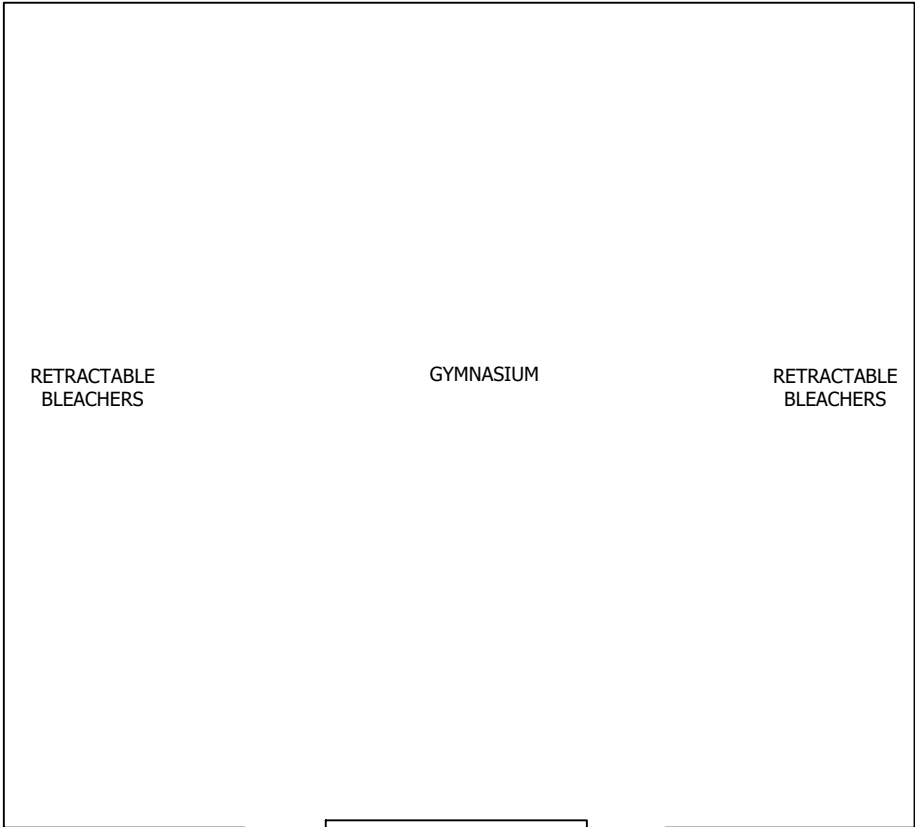

LEGEND	
×	SINKS
○	FOUNTAINS
□	DISH WASHER
△	ICE MACHINE

CHECKED BY:  
T. ABERNATHY

E.W.I. # 232815  
DRAWN BY: CRR  
Nov. 29, 2023

NOT TO SCALE



GYMNASIUM  
(BUILDING D)

GIDEON SCHOOLS  
GIDEON, MISSOURI



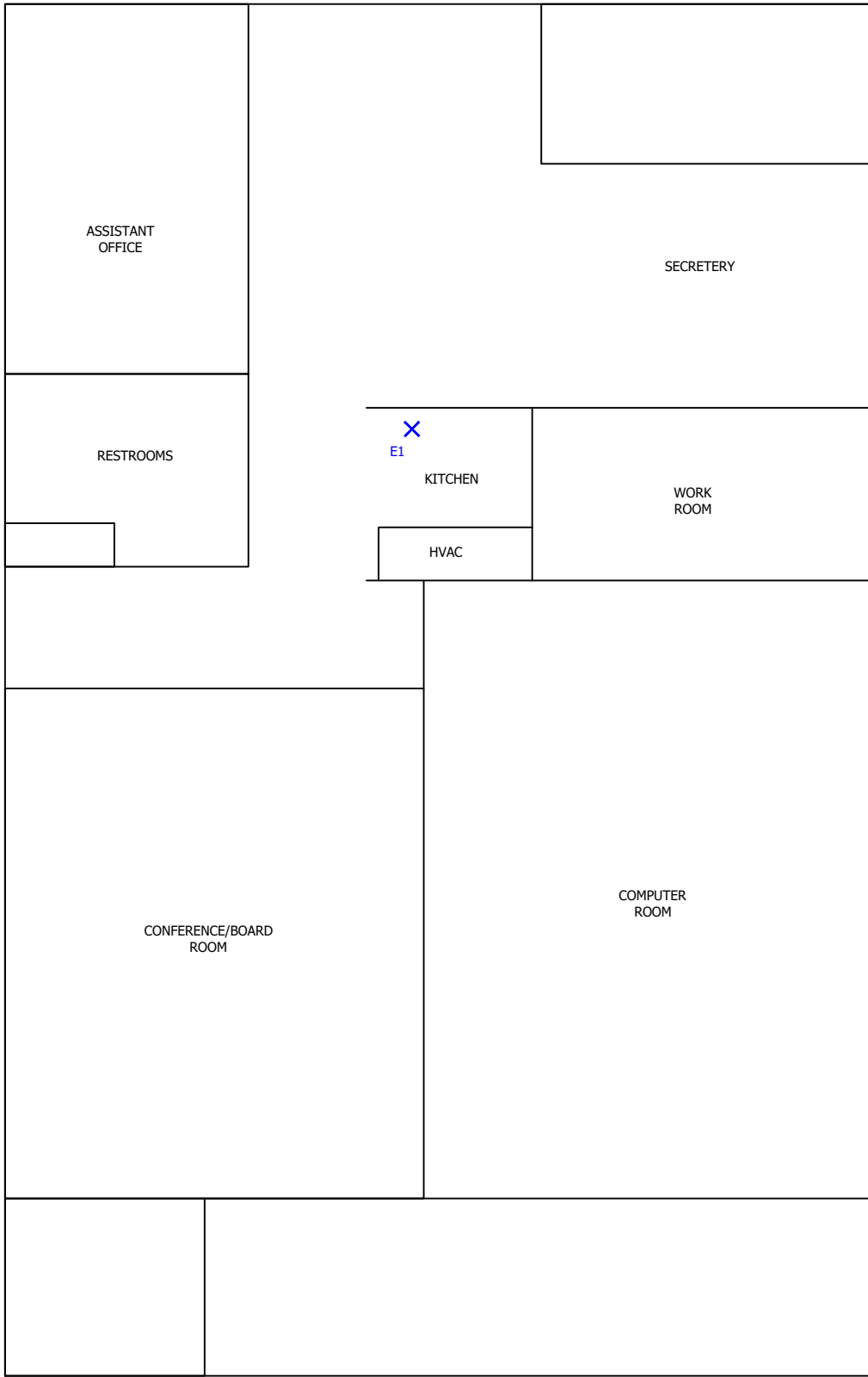

FIGURE  
**4.0**



NORTH



LEGEND

-  SINKS
-  FOUNTAINS
-  DISH WASHER
-  ICE MACHINE

CHECKED BY:  
T. ABERNATHY

E.W.I. # 232815  
DRAWN BY: CRR  
Nov. 29, 2023

NOT TO SCALE



**ENVIRONMENTAL WORKS**  
2008 N. WESTWOOD BLVD, POPLAR BLUFF, MO

CENTRAL OFFICE  
(BUILDING E)

GIDEON SCHOOLS  
GIDEON, MISSOURI

FIGURE

**5.0**

## **APPENDIX B – BUILDING SUMMARY**

**School District:** Gideon No. 37 School District

**Date:** 9/5/2023

**Person Completing Questionnaire:** Mr. James Breece

**Title:** Superintendent

Building	Address	Original Construction Date	Outlet Count	Any Building Additions?			Where Does Water Enter the Building?	Who Provides Water to the Building?	
				Yes/No	Year of Addition	What Was Added?			
Gideon Building A - Elementary School	400 S Main Street, Gideon, MO 63848	1952	6	No	Not Applicable	Not Applicable	Unknown	City of Gideon	
Gideon Building B - High School	400 S Main Street, Gideon, MO 63848	1937	10	No	Not Applicable	Not Applicable	Unknown	City of Gideon	
Gideon Building C - Cafeteria	400 S Main Street, Gideon, MO 63848	1962	10	No	Not Applicable	Not Applicable	Unknown	City of Gideon	
Gideon Building D - Gym	400 S Main Street, Gideon, MO 63848	1959	3	No	Not Applicable	Not Applicable	Unknown	City of Gideon	
Gideon Building E - Central Office	400 S Main Street, Gideon, MO 63848	1947	1	No	Not Applicable	Not Applicable	Unknown	City of Gideon	
			<b>Total Outlets</b>	<b>30</b>					

## **APPENDIX C – OUTLET INVENTORY**

**School District:** Gideon No. 37 / Building A - Elementary School      **Date:** 9/5/23  
**Person Completing Questionnaire:** Mr. James Breece      **Title:** Superintendent

<b>MAP ID</b>	<b>Outlet Type</b> <i>(see examples below)</i>	<b>Location</b> <i>(hall, room #, etc.)</i>	<b>Specific Location</b>	<b>Sample ID</b> Format (Bldg-floor-Outlet-Type-)
A1	Water Fountain	Hallway	Front of RM11	01-01-HW-DW-P-001
A2	Water Fountain	Hallway	Front of RM12	01-01-HW-DW-P-002
A3	Water Fountain	Lower end hall	Front of RM 17	01-01-HW-DW-P-003
A4	Water Fountain/Bottle Filler	Mid Lower end hall	In Front of Restrooms	01-01-HW-BF-P-004
A5	Water Fountain	Mid Lower end hall	In Front of Restrooms	01-01-HW-DW-P-005
A6	Water Fountain	Mid Lower end hall	In Front of Restrooms	01-01-HW-DW-P-006
<b>6</b>	<b>Total Building Outlets</b>			



**School District:**

Gideon No. 37 / Building B - High School

**Date:**

9/5/23

**Person Completing Questionnaire:** Mr. James Breece

**Title**

Superintendent

<b>Map ID</b>	<b>Outlet Type</b> <i>(see examples below)</i>	<b>Location</b> <i>(hall, room #, etc.)</i>	<b>Specific Location</b>	<b>Sample ID</b> Format (Bldg-floor-Outlet-Type-
B1	Water Fountain	Lower Hallway	Across From Office	02-01-HW-BF-P-007
B2	Water Fountain	Lower Hallway	Across From Office	02-01-HW-BF-P-008
B3	Water Fountain	Weight Room	Weight Room	02-01-CR-BF-P-009
B4	Water Fountain	Weight Room	Weight Room	02-01-CR-DW-P-010
B5	Water Fountain	Hallway	Across From FACs RM	02-01-HW-DW-P-011
B6	Faucet	FACS RM 102	FACS RM 102	02-01-CR-KF-P-012
B7	Faucet	FACS RM 102	FACS RM 103	02-01-CR-KF-P-013
B8	Dishwasher	FACS RM 102	FACS RM 104	02-01-CR-DISH-P-014
B9	Faucet	FACS RM 102	FACS RM 105	02-01-CR-KF-P-015
B10	Faucet	FACS RM 102	FACS RM 106	02-01-CR-KF-P-016
<b>10</b>	<b>Total Building Outlets</b>			

**School District:**

Gideon No. 37 / Building C - Cafeteria

**Date:** 9/5/23

**Person Completing Questionnaire** Mr. James Breece

**Title** Superintendent

<b>Map ID</b>	<b>Outlet Type</b> <i>(see examples below)</i>	<b>Location</b> <i>(hall, room #, etc.)</i>	<b>Specific Location</b>	<b>Sample ID</b>
				Format (Bldg-floor-Outlet-Type-
C1	Water Fountain	Hallway	Next to Mens Restroom	03-01-HW-DW-P-017
C2	Water Fountain	Hallway	Next to Mens Restroom	03-01-HW-DW-P-018
C3	Water Fountain	Cafeteria	Cafeteria	03-01-CAF-DW-P-019
C4	Water Fountain	Cafeteria	Cafeteria	03-01-CAF-DW-P-020
C5	Ice Machine	Kitchen	Kitchen	03-01-KIT-IM-P-021
C6	Faucet	Kitchen	Kitchen	03-01-KIT-KF-P-022
C7	Faucet	Kitchen	Kitchen	03-01-KIT-KF-P-023
C8	Faucet	Kitchen	Kitchen	03-01-KIT-KF-P-024
C9	Faucet	Kitchen	Kitchen	03-01-KIT-KF-P-025
C10	Dishwasher	Kitchen	Kitchen	03-01-KIT-DISH-P-026
<b>10</b>	<b>Total Building Outlets</b>			

**School District:**

Gideon No. 37 / Building D - Gym

**Date:** 9/5/23

**Person Completing Questionnaire** Mr. James Breece

**Title** Superintendent

<b>Map ID</b>	<b>Outlet Type</b> <i>(see examples below)</i>	<b>Location</b> <i>(hall, room #, etc.)</i>	<b>Specific Location</b>	<b>Sample ID</b> Format (Bldg-floor-Outlet-Type-Sample)
D1	Water Fountain	Lobby	Lobby	04-01-HW-DW-P-027
D2	Water Fountain	Lobby	Lobby	04-01-HW-DW-P-028
D3	Ice Machine	Mecanical	Next to Lobby	04-01-CR-IM-P-029
<b>3</b>	<b>Total Building Outlets</b>			

**School District:** Gideon No. 37 / Building E - Central Office **Date:** 9/5/23  
**Person Completing Questionnaire** Mr. James Breece **Title** Superintendent

<b>Map ID</b>	<b>Outlet Type</b> <i>(see examples below)</i>	<b>Location</b> <i>(hall, room #, etc.)</i>	<b>Specific Location</b>	<b>Sample ID</b> Format (Bldg-floor-Outlet-Type-
E1	Faucet	Kithchen	Kithchen	05-01-KIT-KF-P-30
<b>1</b>	<b>Total Building Outlets</b>			